

GT02 2.2" Beadlock wheel instructions

Pieces included

- M2.5 nuts x 16
- 2.5 x 16mm bolts x 2
- 2.5 x 8mm hex bolts x 32
- Front half of wheels x 2
- Back half of wheels x 2
- Inner beadlock wheels x 2
- Wheel cap x 2
- Wheel cap sticker x 2

2.2" series tire
(not included)

Inner foam
(not included)

⚠ Please be careful with the direction.



Outer side

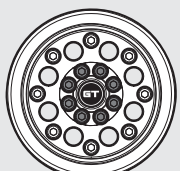
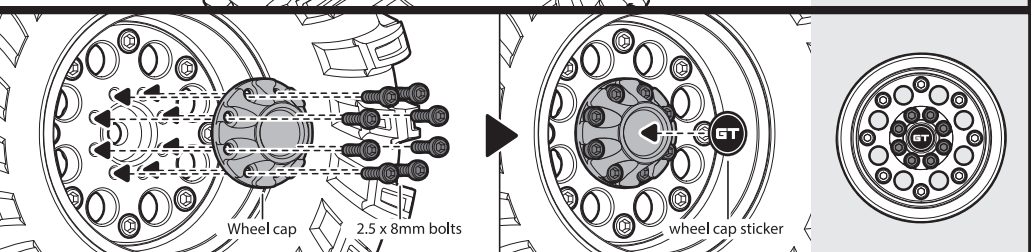
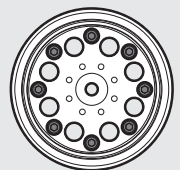
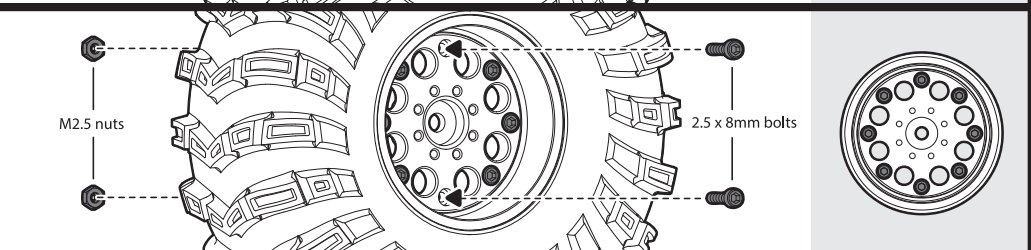
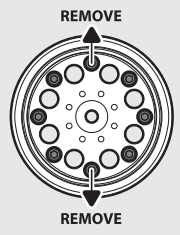
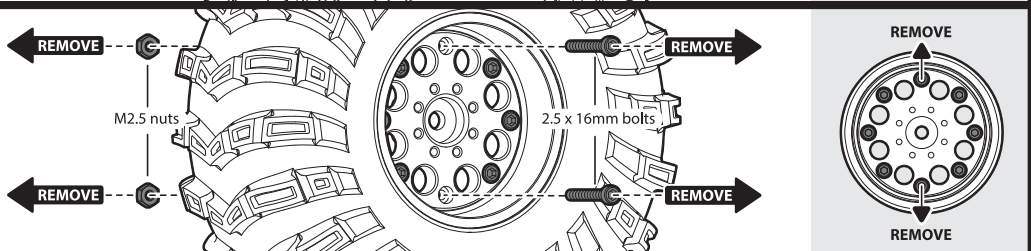
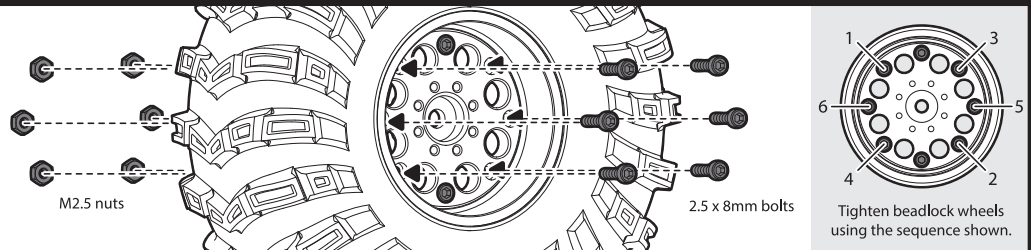
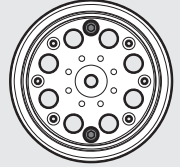
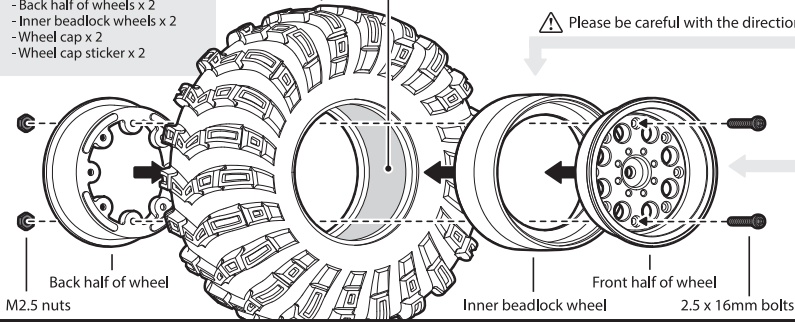

⚠ - Do not over tighten screws.
- Please read all instructions prior to assembling beadlock wheels